

INDEX OF SHEETS

- 1 TITLE SHEET
- 2 SUMMARY & SCHEDULE OF QUANTITIES
- 3 TYPICAL SECTIONS
- 4-5 PLAN SHEETS

QC/QA CONTRACT

ENGINEERING DIVISION
CITY OF GALESBURG, ILLINOIS

**PLANS FOR PROPOSED
PAVEMENT PATCHING**

LINWOOD ROAD AND CARL SANDBURG DRIVE
SECTION NUMBER 20-01003-42-GM
CITY GAS TAX FUNDS

SECTION #	TOTAL SHEETS	SHEET NO.
20-01003-42-GM	5	1

- HIGHWAY STANDARDS**
- 000001-07 STANDARD SYMBOLS, ABBREVIATIONS AND PATTERNS
 - 420001-09 PAVEMENT JOINTS
 - 442201-09 CLASS C & D PATCHES
 - 701301-04 LANE CLOSURE, 2L, 2W, SHORT TIME OPERATIONS
 - 701501-06 URBAN LANE CLOSURE, 2L, 2W, UNDIVIDED
 - 701601-09 URBAN LANE CLOSURE, 1W2W WITH NONTRYSBLE MEDIAN
 - 701701-10 URBAN LANE CLOSURE W MULTI LANE INTERSECTION
 - 701901-08 TRAFFIC CONTROL DEVICES

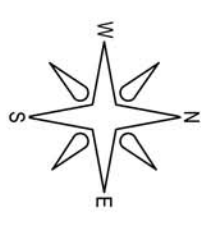

GENERAL LOCATION MAP
NOT TO SCALE

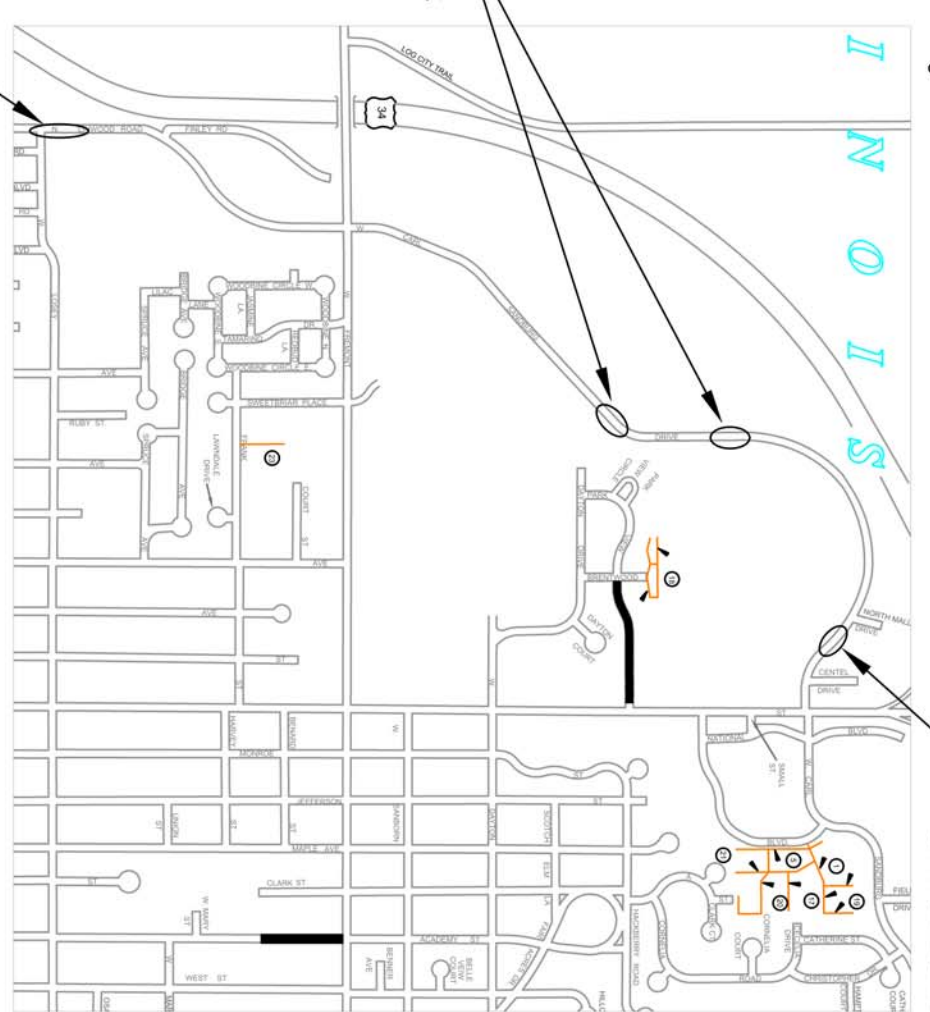

LOCATION #2 & 3:
1324 W CARL SANDBURG DR
(KNOX COUNTY YMCA)

LOCATION #1:
NORTH OF INTERSECTION OF
LINWOOD RD & LOSEY ST.

LOCATION #4:
ACROSS FROM
907 W CARL SANDBURG DR

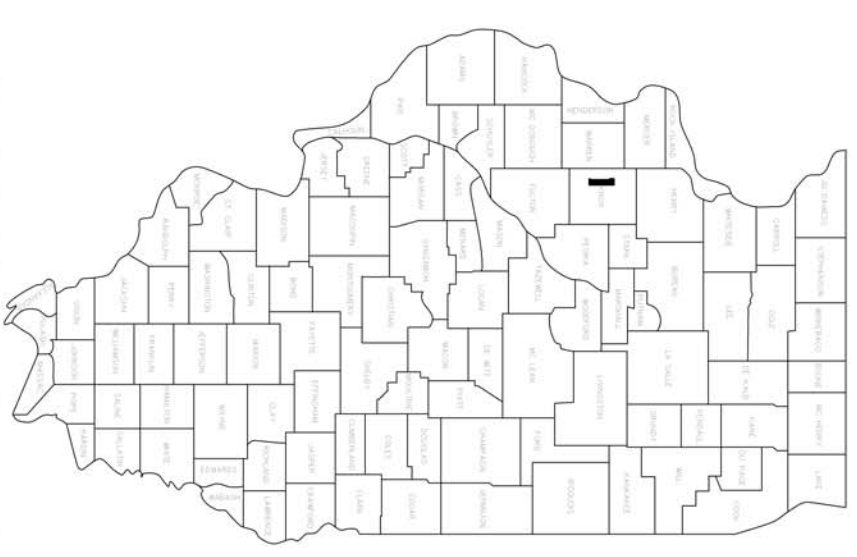

LOCATION OF SECTION INDICATED THUS: ■

PROJECT DESCRIPTION:

THE PROJECT INCLUDES REMOVAL AND REPLACEMENT OF
PCC PAVEMENT AND PCC CURB ON VARIOUS SECTIONS OF
LINWOOD ROAD AND WEST CARL SANDBURG DRIVE

CALL J.JULIE
BEFORE DIGGING
800-892-0123



AARON J. GAVIN, P.E.
P.E. NO. 062-068200
EXP. DATE 11/30/2021

APPROVED _____ 2020

CITY OF GALESBURG, CITY ENGINEER.

TITLE SHEET
PAVEMENT PATCHING
SECTION # 20-01003-42-GM

SUMMARY OF QUANTITIES

PAY CODE	PAY ITEM	UNITS	QUANTITY
60404300	FRAME & GRATE, TY 3	EA	3
67100100	MOBILIZATION	L SUM	1
X7010216	TRAFFIC CONTROL & PROTECTION (SPECIAL)	L SUM	1
ZZ000001	CLASS C PATCH, TY IV, 8" (SPL)	SY	50
ZZ000002	CLASS C PATCH, TY IV, 9" (SPL)	SY	316

SCHEDULE OF QUANTITIES

60404300	EACH
TY 3 FRAME & GRATE	
LOCATION 1, PATCH 1	1
LOCATION 2, PATCH 3	1
LOCATION 4, PATCH 6	1.0
TOTAL	3.0 EACH
67100100	L SUM
MOBILIZATION	
ENTIRE PROJECT	1
TOTAL	1.0 L SUM

X7010216	L SUM
TRAFFIC CONTROL & PROTECTION (SPL)	
ENTIRE PROJECT	1
TOTAL	1.0 L SUM
ZZ000001	SQYD
CLASS C PATCH, TY IV, 8" (SPL)	
LOCATION 1, PATCH 1	50.1
TOTAL	50.0 SQ YD

ZZ000002	SQYD
CLASS C PATCH, TY IV, 9" (SPL)	
LOCATION 2, PATCH 2	90.7
LOCATION 2, PATCH 3	90.7
LOCATION 3, PATCH 4	27.8
LOCATION 4, PATCH 5	53.4
LOCATION 4, PATCH 6	53.4
TOTAL	316.0 SQYD

SUMMARY AND SCHEDULE OF QUANTITIES

PAVEMENT PATCHING
SECTION #20-01003-42-GM

SECTION #	TOTAL SHEETS	SHEET NO.
20-1003-42-GM	5	3
NOTE: REFER TO STD. 420001-09 FOR REBAR REQUIRED FOR PATCHES OVER 20' IN LENGTH		

LINWOOD ROAD
LOCATION 1
 *NOT TO SCALE
 TYPICAL SECTION

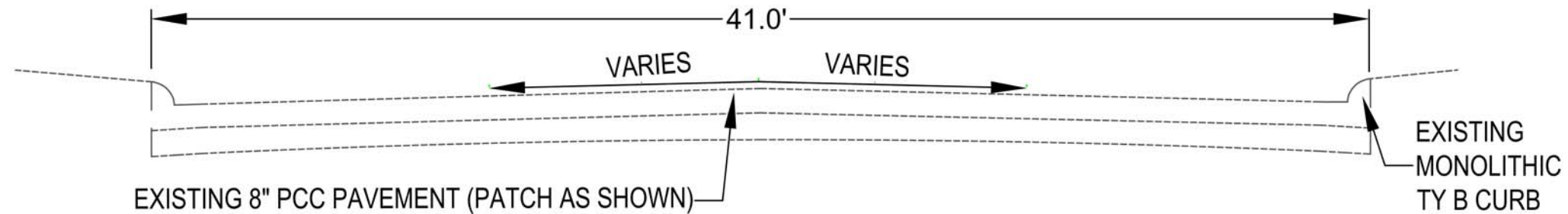

W. CARL SANDBURG DRIVE
LOCATIONS 2 & 3
 *NOT TO SCALE
 TYPICAL SECTION

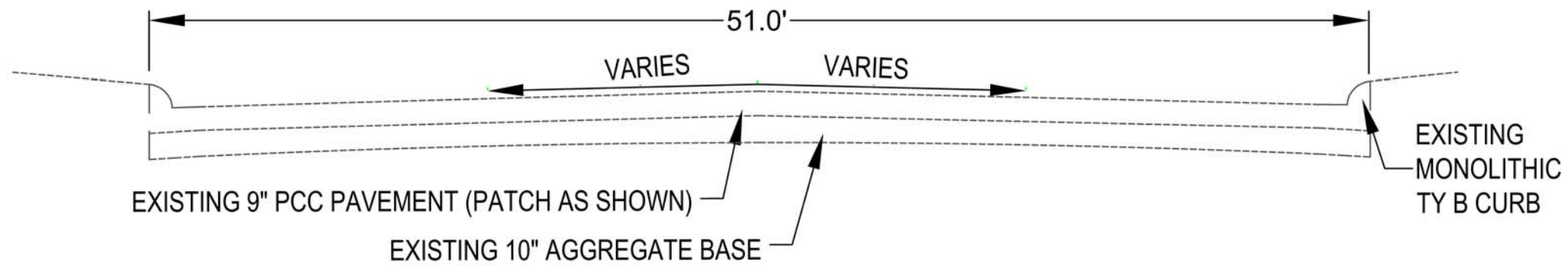

W. CARL SANDBURG DRIVE
LOCATION 4
 *NOT TO SCALE
 TYPICAL SECTION

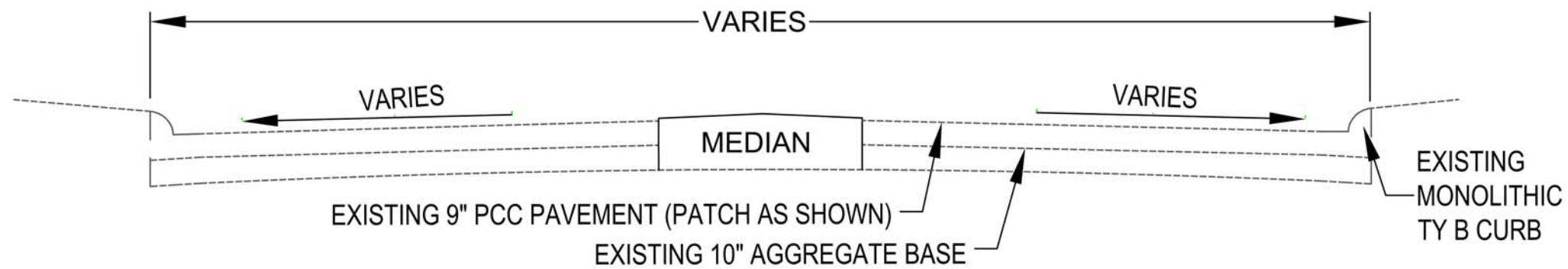

TYPICAL SECTIONS
 PAVEMENT PATCHING
 SECTION #20-01003-42-GM

SECTION #	TOTAL SHEETS	SHEET NO.
20-01003-42-GM	5	4

LEGEND

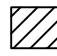
	CL C PATCH TY IV, 8"
	CL C PATCH TY IV, 9"

LOCATION 1

LOCATION 2

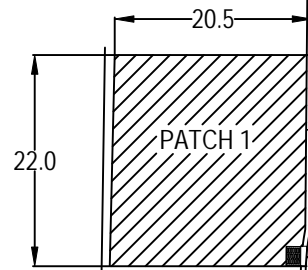

TY B CURB POURED
MONOLITHIC W/ PATCH

NEW TY 3
FR & GR

LINWOOD ROAD

W LOSEY STREET

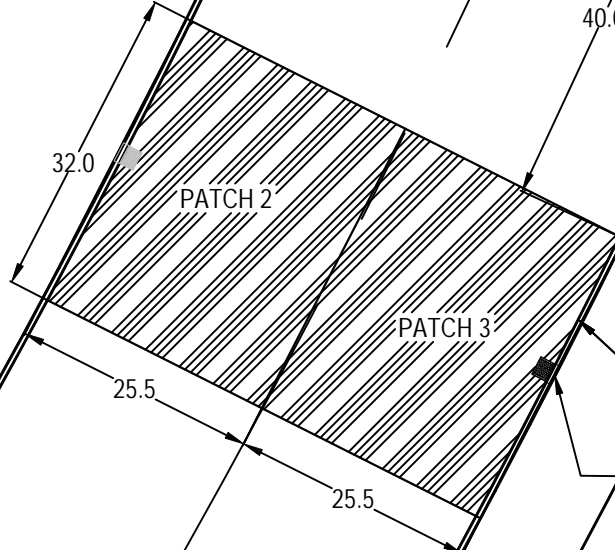

TY B CURB POURED
MONOLITHIC W/ PATCH
(BOTH SIDES)

NEW TY 3
FR & GR

W CARL SANDBURG DRIVE

S ENTRANCE TO
YMCA PARKING
(SOCCER FIELDS)

PLAN SHEET

PAVEMENT PATCHING
SECTION #20-01003-42-GM

SECTION #	TOTAL SHEETS	SHEET NO.
20-01003-42-GM	5	6

LEGEND

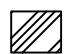
	CL C PATCH TY IV, 8"
	CL C PATCH TY IV, 9"

LOCATION 3



LOCATION 4

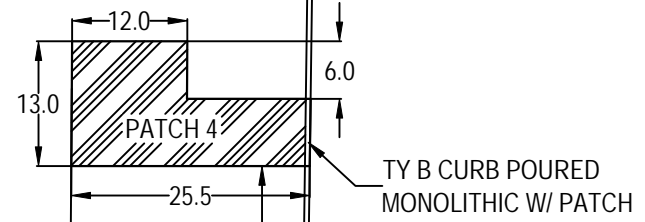

W CARL SANDBURG DRIVE

50.0

EXIT TO YMCA CIRCLE DRIVE

BUS STOP

NEW TY 3
FR & GR
TY B CURB POURED
MONOLITHIC W/ PATCH
(BOTH SIDES)

MALL PARKING LOT

HOTEL ENTRANCE

24.0

13.0

13.0

37.0

PATCH 5

PATCH 6

WB LANE W CARL SANDBURG DRIVE

EB LANE W CARL SANDBURG DRIVE

PLAN SHEET

PAVEMENT PATCHING
SECTION #20-01003-42-GM